



UNIVERSITY LIBRARIES

Main Library Hours

Mon—Thurs:	7am—2am
Fri:	7am—10pm
Sat:	9am—10pm
Sun:	10am—2am

Main Library Lending Desk:
303.871.3707

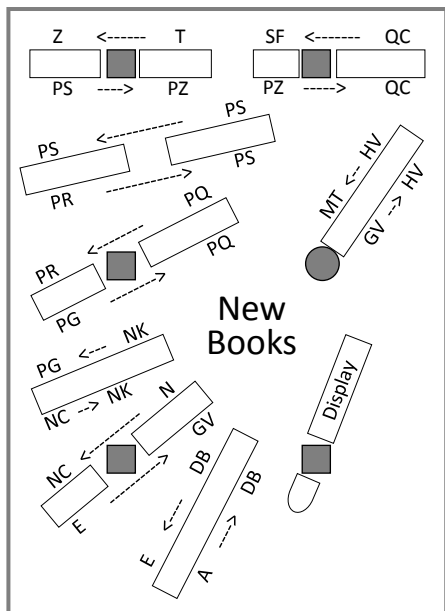

Main Level

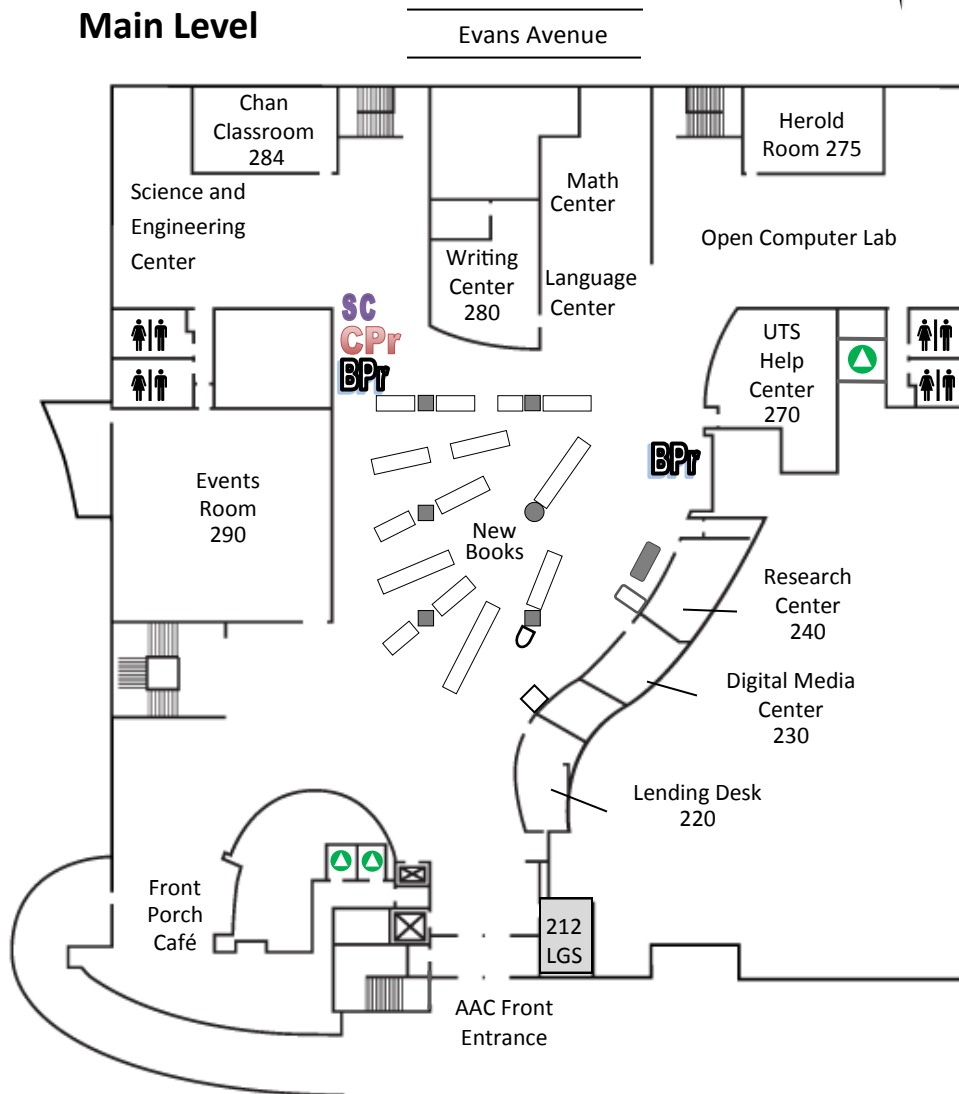

Need research help?

Call the Crossley Research Center at 303-871-2905, select **ASK US** at library.du.edu, or visit libraryhelp.du.edu

Questions about borrowing or library access?

Contact the Perlmutter Lending Desk at 303-871-3707

Interested in Special Collections and Archives?

Contact Special Collections & Archives at 303-871-3428

Book and Materials Paging

The Library will retrieve items for you from the Anderson Academic Commons stacks as well as the Hampden Center off-site storage facility.

Use the "Request It" button to request items in the online catalog at library.du.edu. Most items will be ready for pick up within a few hours. You will receive an email when your items are available.

	Elevators		CPr Color Printer		Gender Neutral Restrooms
	Stairs		SC Scanner		Restrooms
	BPr Black & White Printer		Copier On Lower Level		Lactation Room
	LGS Large Group Study		SGS Small Group Study		Shower

Library of Congress Classification

- | | | | |
|------------------------------|---------------------|------------------------------|------------------------------------|
| A General Works | H Social Sciences | Q General Science | R Medicine |
| B Philosophy and Religion | J Political Science | QA Math and Computer Science | S Agriculture |
| C History: General | K Law* | QB Astronomy | T Technology and Engineering |
| D History: Old World | L Education | QC Physics | U Military Science |
| E History: Americas | M Music** | QD Chemistry | V Naval Science |
| G Geography and Anthropology | N Fine Arts | QE Zoology | Z Bibliography and Library Science |
| | P Literature | QH-QR Biological Sciences | |

* Law Collection is concentrated in the Westminster Law Library, 2255 E. Evans Ave. 303.871.6188
 ** Music Collection is concentrated in the Lamont School of Music, Newman Center for the Performing Arts, 2344 E. Iliff Ave. 303.871.6421

Lower Level

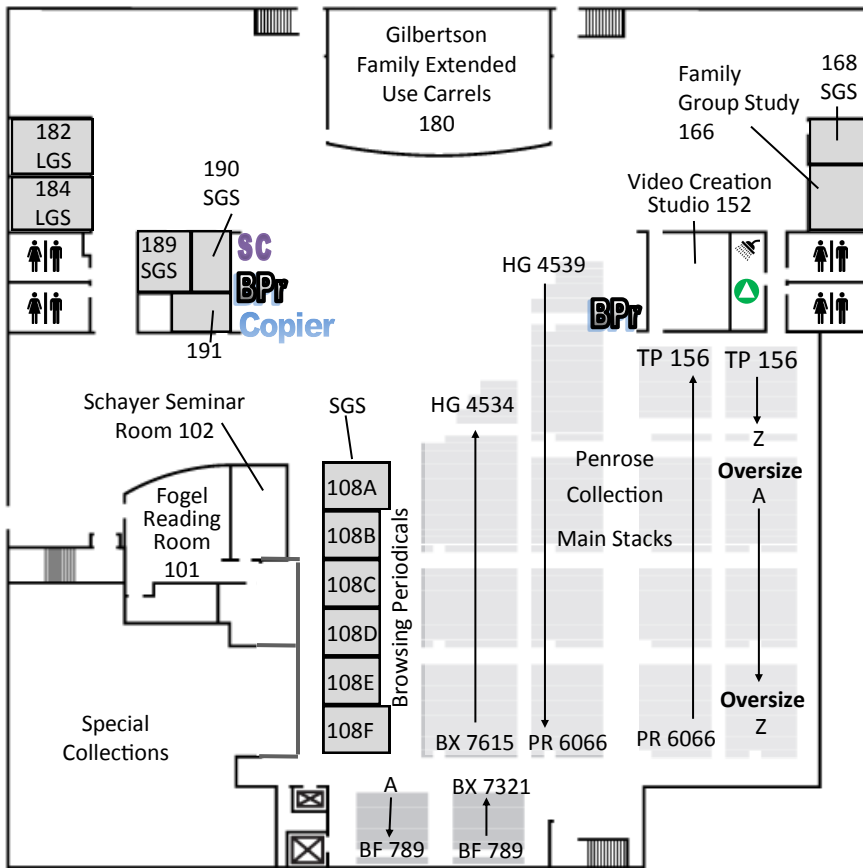

Upper Level

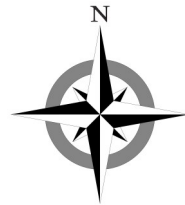
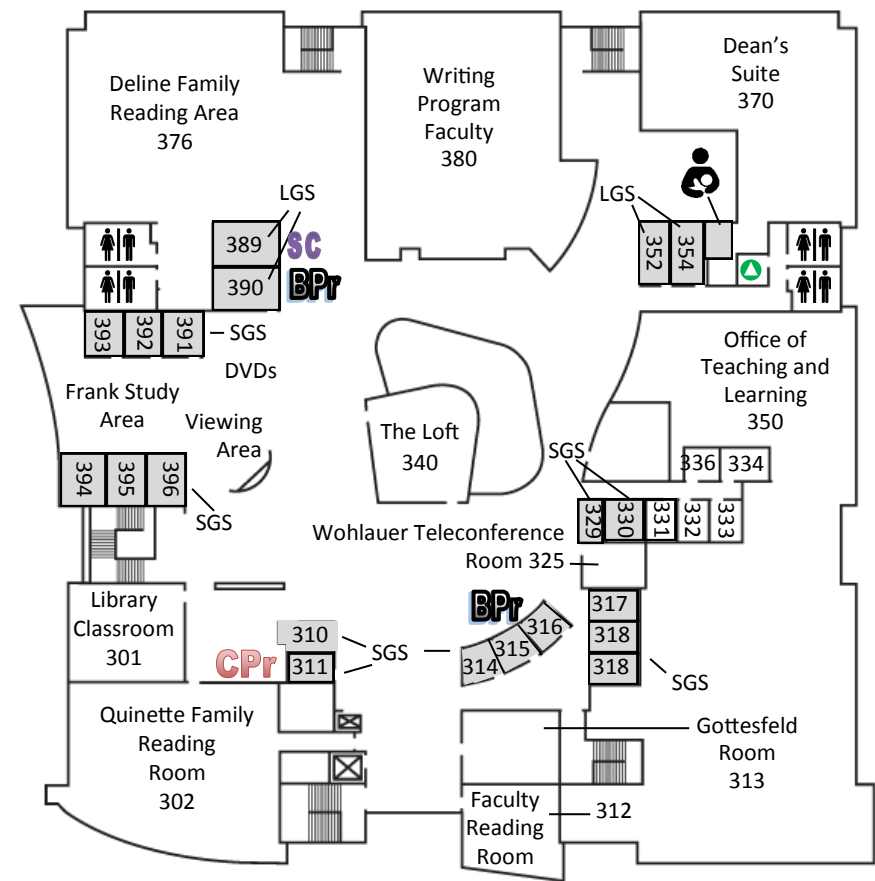

Large Group Study Rooms (LGS)	Lower Level Rooms: 182, 184	Upper Level Rooms: 389, 390, 352, 354 Main Level Room: 212
Small Group Study Rooms (SGS)	Lower Level Rooms: 108A - 108F, 168, 189 - 191	Upper Level Rooms: 310, 311, 314 - 316, 318, 319, 329 - 331, 391 - 396

Elevators	Color Printer	Gender Neutral Restroom
Stairs	Scanner	Restrooms
Black & White Printer	On Lower Level	Lactation Room
Large Group Study	Small Group Study	Shower